



Bixelon Label Printer Guide

Pairing the printer to your iPad

1. From the iPad's home screen, tap **Settings**.



2. Tap **Bluetooth**.

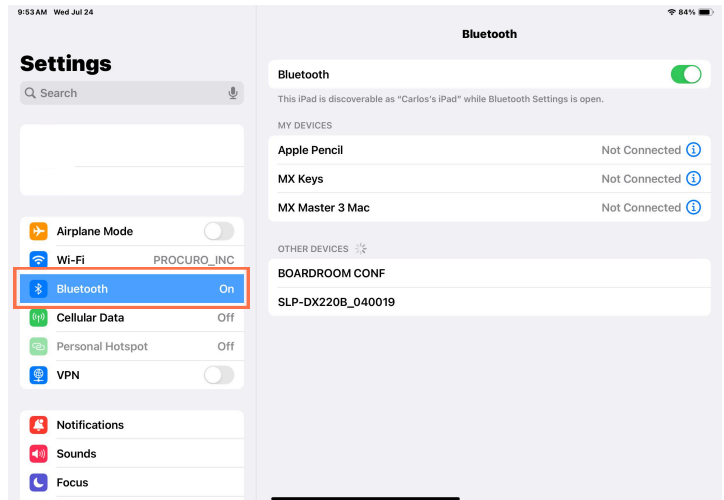

3. Ensure the Bluetooth slider to ON (green). In a few seconds, a list of all the Bluetooth devices near you will appear under "Other Devices".

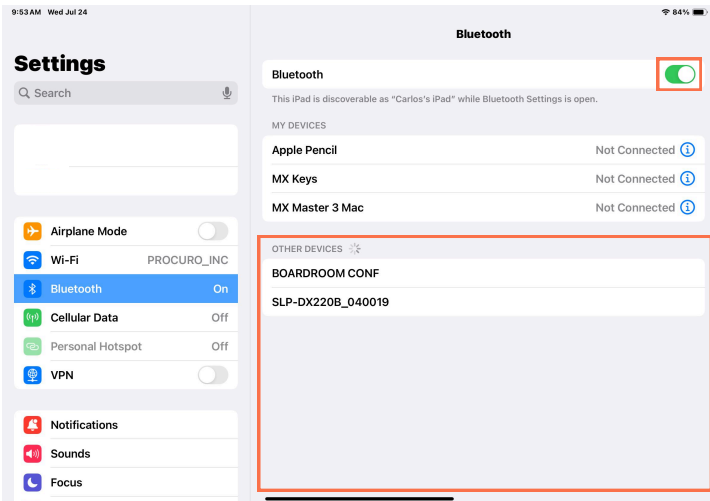

4. Tap the Bixelon printer. The name will always start with **SLP-DX220**, and enter the PIN Number **0000** in the pop-window. Then tap the **PAIR** button in the pop-up.

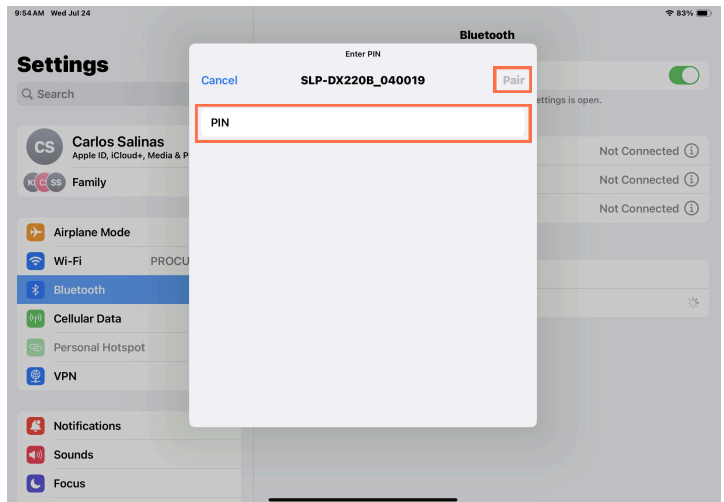

5. Printer will now display "Connected" and is ready to print.

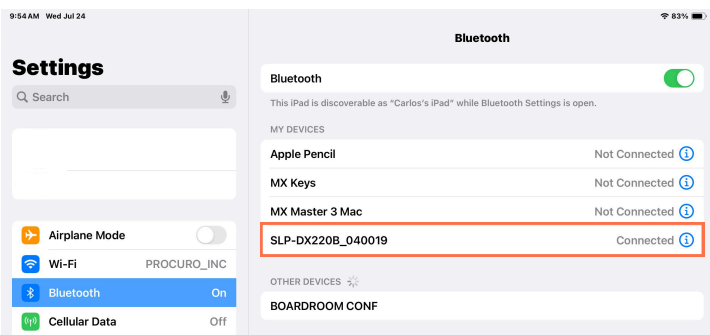

Installing a label roll

SCAN FOR VIDEO



1. Open the Paper Cover.

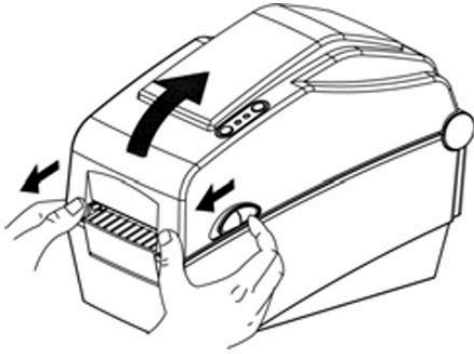

2. The printing surface must face up when inserting the paper roll.



3. Spread the Paper Holder and insert paper roll.

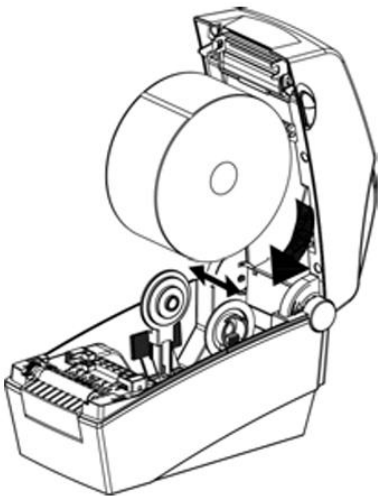

4. Adjust the paper guide to the width of the paper.

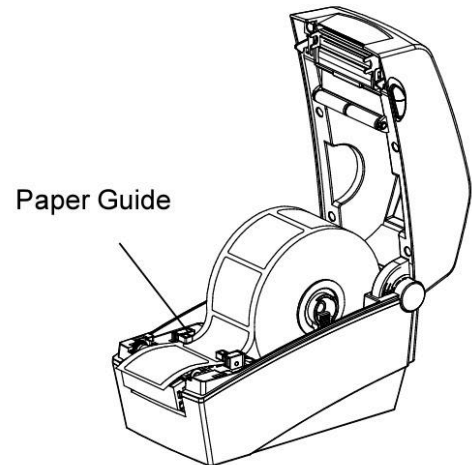

5. Close the Paper Cover until a click sound is heard.

